

No.	DESCRIPTION:	DATE:
1	DRC APPLICATION	06/11/2024
2	DRC APPLICATION REV.1	11/13/2024
3	DRC APPLICATION REV.2	02/12/2025

NOT FOR CONSTRUCTION

Discrepancies must be reported immediately to the Architect before proceeding.
Only figured dimensions are to be used.
Contractors must check all dimensions on site.

CONSULTANT:

WEST 8 WEST 8 URBAN DESIGN &
LANDSCAPE ARCHITECTURE P.C.

DRAWING TITLE: SCALE: 1"=10'

LANDSCAPE PLAN

SHEET No.:

110-L-110

SEAL:

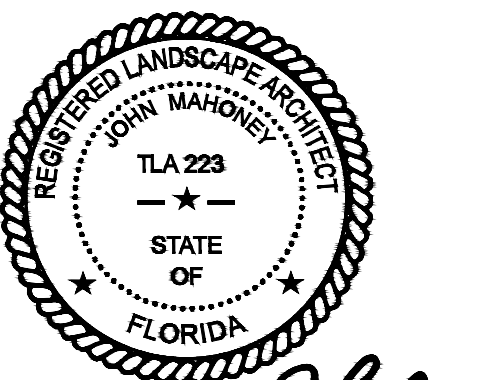

SIGNATURE:

J. Mahoney

All drawing and written materials herein constitute original work of the architect and may only be duplicated with their written consent.

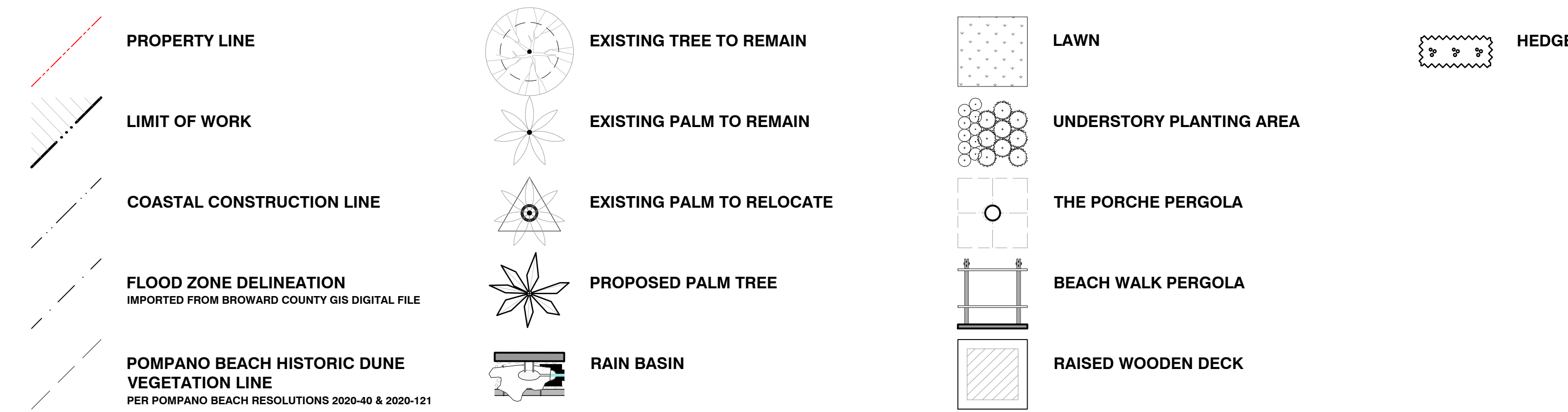
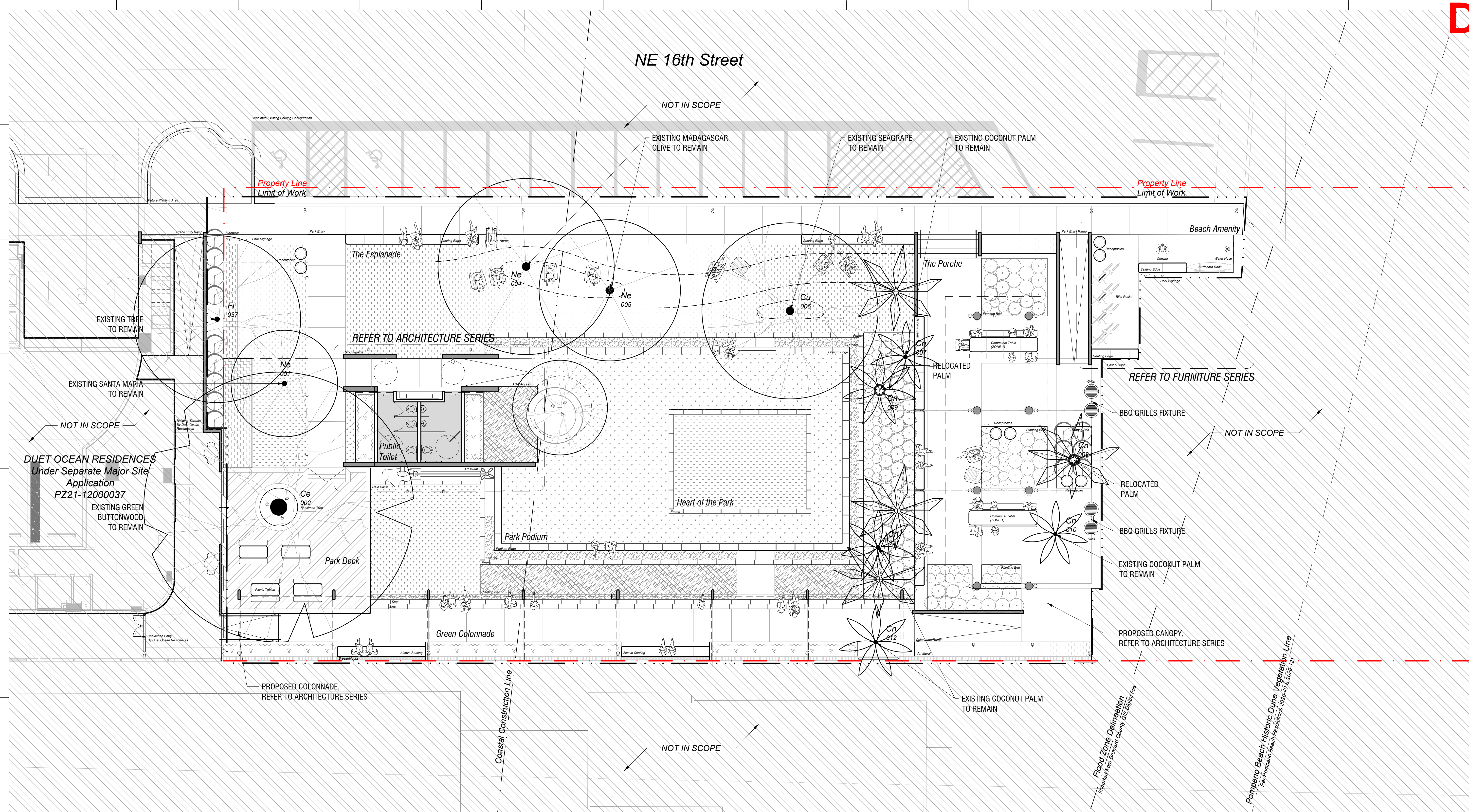

- COMPOSITE SITE PLAN NOTES:
- ALL SURFACE MATERIALS TO BE REVIEWED PRIOR TO CONSTRUCTION FOR STRUCTURAL LOADING COMPLIANCE WITH APPLICABLE CITY CODES, ADA STANDARDS, AND PROJECT SPECIFIC REPORTS.
 - SPECIFIED PLANT AND TREE SPECIES PER POMPAÑO BEACH LIST OF APPROVED SPECIES. PLANT LIST TO BE REVIEWED IN CONJUNCTION WITH PROJECT WIND REPORT BY APPROVED NURSERY OR ARBORIST PRIOR TO PROCUREMENT AND DELIVERY.
 - DO NOT SCALE FROM DRAWINGS. ALL DIMENSIONS TO BE VERIFIED IN FIELD. ANY DISCREPANCY BETWEEN SITE CONDITIONS AND DESIGN DIMENSIONS TO BE BROUGHT TO THE ATTENTION OF THE LANDSCAPE ARCHITECT PRIOR TO FABRICATION AND INSTALLATION.
 - ALL SURFACE MATERIALS, INSTALLATION AND BUILD UP TO BE CONSTRUCTED ACCORDING TO APPLICABLE CITY CODE AND VERIFIED BY STRUCTURAL ENGINEER FOR WIND LOADS AND UPLIFT.
 - CAPACITY AND SIZING OF DRAINAGE INFRASTRUCTURE PER CIVIL ENGINEER.
 - LAYOUT, DIMENSION, AND TECHNICAL SPECIFICATIONS OF ALL CONTROL AND EXPANSION JOINTS TO BE SUBMITTED BY CONTRACTOR FOR REVIEW AND APPROVAL BY PROJECT ENGINEER PRIOR TO CONSTRUCTION OR FABRICATION. LAYOUT TO BE VERIFIED IN FIELD.
 - MINIMUM LIGHTING LEVELS TO BE COMPLIANT PER APPLICABLE CITY CODES, LAYOUT, DETAIL, AND LUMENS PER LIGHTING CONSULTANT.
 - ALL SITE WORK TO BE COORDINATED WITH ADJOINING MAJOR SITE APPLICATION PZ21-12000037